

ASSEMBLY INSTRUCTIONS

**WALL CABINET (W2412, W2712, W3012, W3312, W3612)
(W2415, W2715, W3015, W3315, W3615)
(W2418, W2718, W3018, W3318, W3618)
(W301224, W361224)**

CABINET PARTS LIST

A-Doors & Face Frame B-End Panels(2) D-Bottom Panel &Top Panel E-Back Panel

HARDWARE PARTS LIST

1. Screws (Ø3.5*25) 12 or 16

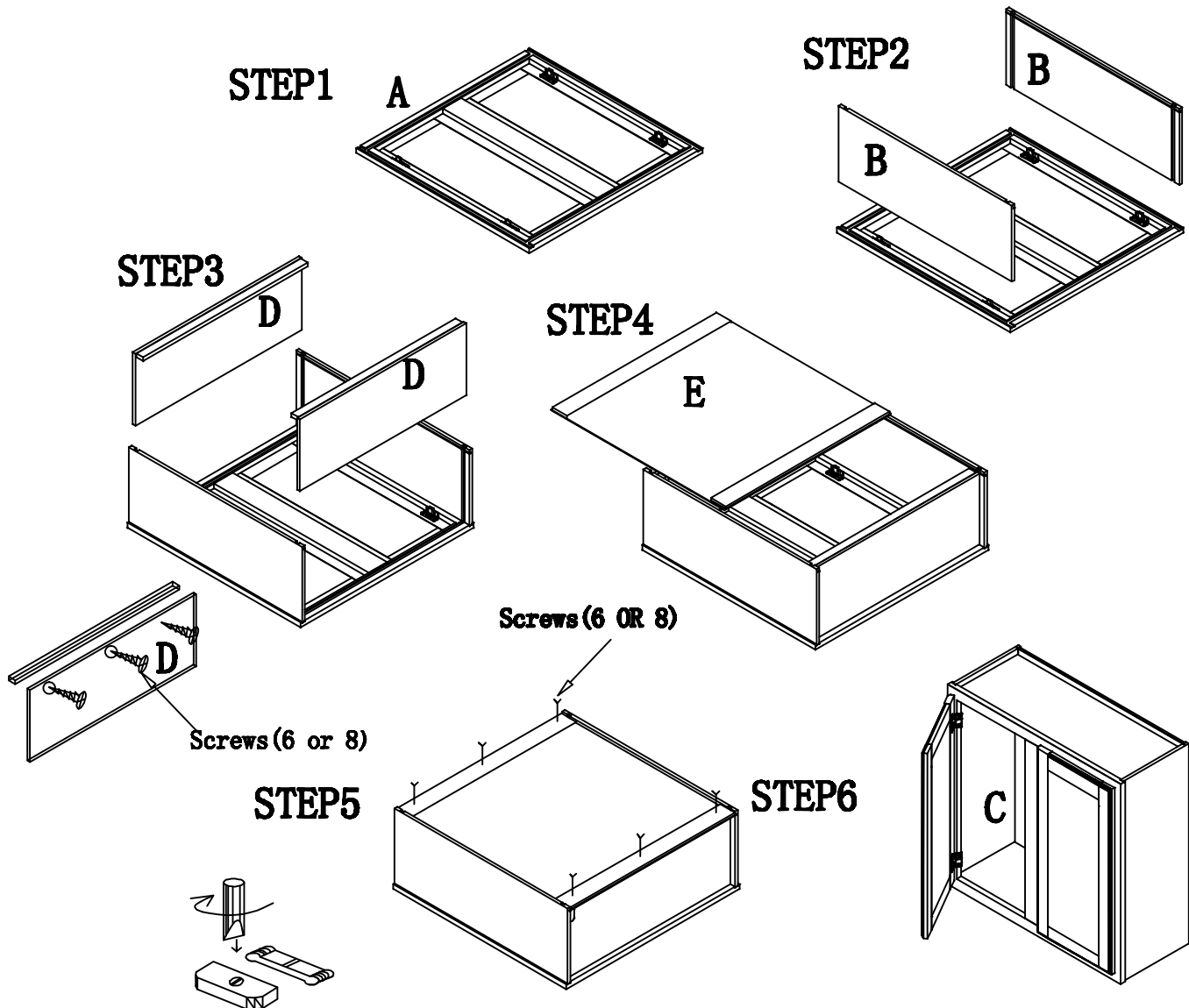

Your cabinet is complete. For installation, consult a professional contractor or building supplier for the proper installation method or materials to be used for your existing wall condition (e.g., wood, concrete, tile, etc.).